

Software Update Instructions for Scan Tool

PC System Requirements: 486 PC with at least 4MB of RAM, Microsoft Windows 95 or Newer, CD-ROM drive, Adobe Acrobat Reader Software

Update Package includes:

CD, CD Serial Number Labels (2 ea.), Instructions, Cable (If not with Scan Tool)

**Affix CD-ROM
Serial Number Label**

Authorization Number: _____

The 9640UC upgrade gives the following enhancements to the 9640:

- GM Enhanced Coverage for 2002 and 2003
- Ford Enhanced Coverage for 2002 and 2003
- Chrysler Enhanced Coverage for 2002 and 2003
- 1996 - 2003 Toyota Enhanced DTC Requests and Definitions
- Asian and European Coverage
- Updated user's manual

NOTE: *The manual on CD is a replacement of the existing manual.*

The manual is in Adobe Acrobat format on the same CD as the new software.

Adobe Acrobat Reader software is available for download from www.adobe.com.

NOTE: *A CAN Adapter Board MUST be present for software upgrade. If Board is not present Scan Tool displays "CAN Adapter Not Present. Software not compatible with hardware. (Adapter board upgrade available from your dealer.)"*

1. Remove Serial Number Labels and place on CD on space provided.

NOTE: *Place label on same side as writing on disk.*

NOTE: *To Register Software call Technical Support at 1-800-228-7667 from 8:00 AM - 6:00 PM EST. A computer is not required for an authorization number but is required to update software.*

2. Register and write Authorization Number for software in space provided.

NOTE: *Any serial port will work on computer.*

3. Connect serial cable from serial port on computer to Scan Tool.

NOTE: *Make sure Scan Tool has good batteries.*

4. Turn Scan Tool ON.

5. Place Scan Tool in **Program Mode**.

NOTE: *Scan Tool will display "PROGRAM MODE SEE USER MANUAL."*

6. Close all programs on computer and install CD.

7. Click **Start** then **R**un on computer.

NOTE: *"x" is the CD-ROM drive letter on the computer.*

8. Type "x:\scanupdate.exe" in Open box on computer.

9. Follow screen prompts on computer to complete software download.

NOTE: *If downloading process stops, repeat downloading process.*

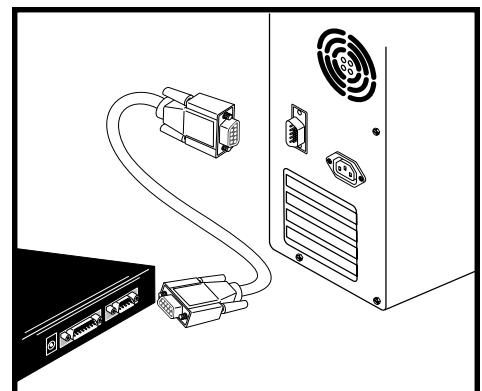

Installing Internet Update Software

NOTE: The Internet Update Software is used to update Scan Tool with future revisions of Software for Scan Tool

1. Close all programs on computer and install CD.

2. Click **Start** then **R**un on computer.

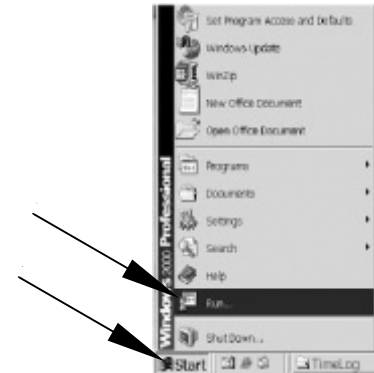

NOTE: "x" is the CD-ROM drive letter on the computer.

3. Type "x:\InternetUpdate\setupiu.exe" in Open box on computer.



4. Follow screen prompts on computer to complete software download.

Using Internet Update Software

NOTE: Computer **MUST** be connected to internet and scan tool **MUST** be connected to computer to run internet update software.

1. Connect serial cable from serial port on computer to scan tool.

NOTE: Make sure scan tool has good batteries.

2. Turn scan tool ON.

3. Place scan tool in **Program Mode**.

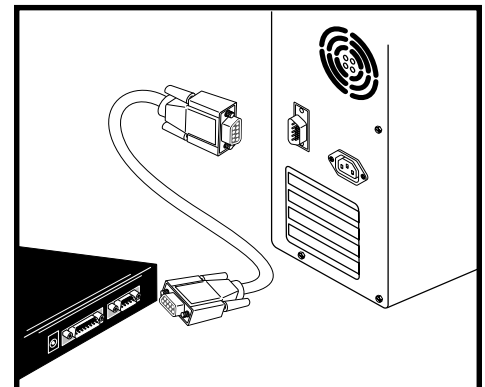

NOTE: Scan tool will display "PROGRAM MODE SEE USER MANUAL"

4. Open Internet Update Software Program on computer.

5. Follow screen prompts on computer to do internet updates.